

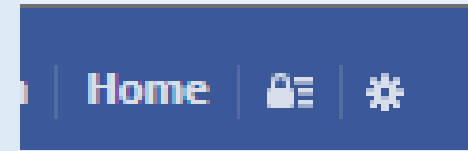





Do you know who can see your profile?



Check your privacy settings



Privacy Shortcuts 

 Who can see my stuff? 

 Who can contact me? 

 How do I stop someone from bothering me? 

[See More Settings](#)

Click here for a shortcut to your privacy settings

Who can see your profile?

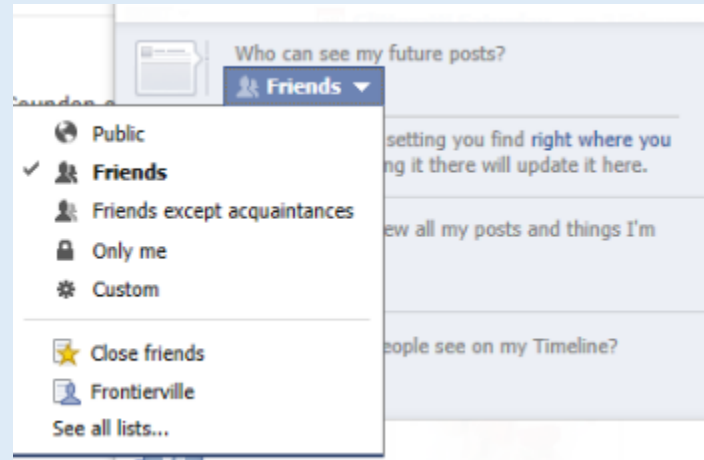
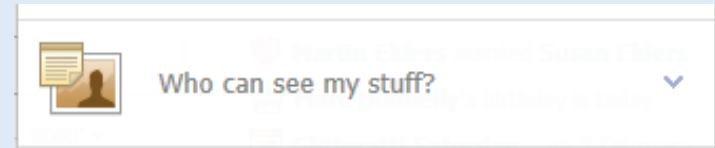

Set it to friends or for increased security set it to friends except acquaintances

This allows you to check posts/pictures you have been tagged in and all of your posts.

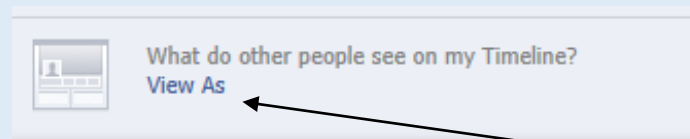

This allows you to see what you're the general public can see on your profile.

Who can contact you?

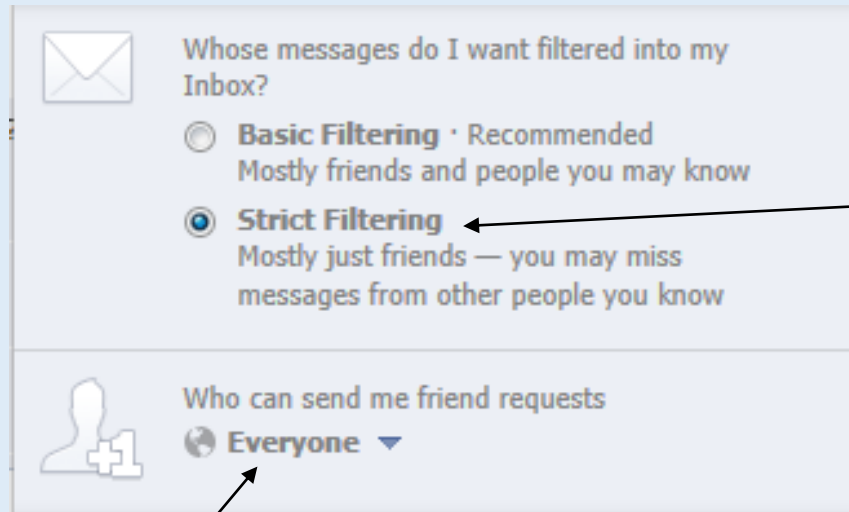
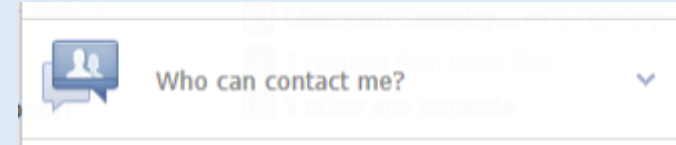

Strict filtering allows only friends to contact you, this is the safest option

You can either set this to everyone or friends of friends.

REMEMBER – Don't accept anyone you don't know!!

Do you need to block someone?

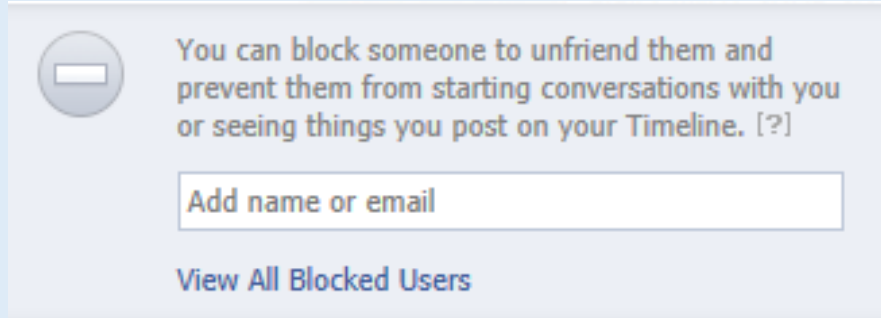
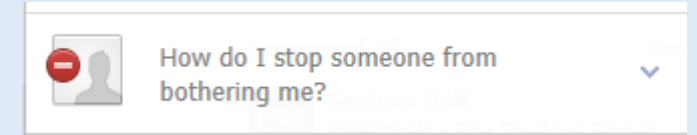

If you need to block someone and stop them from contacting you, add their name or email address here.

Other privacy settings

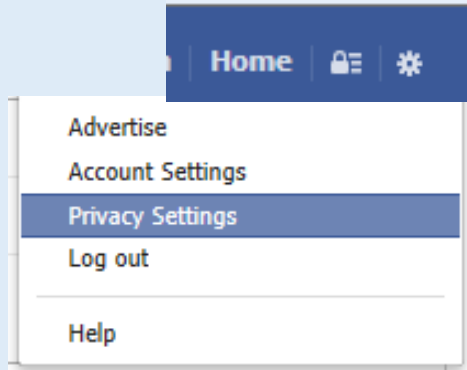

Delete / hide past posts

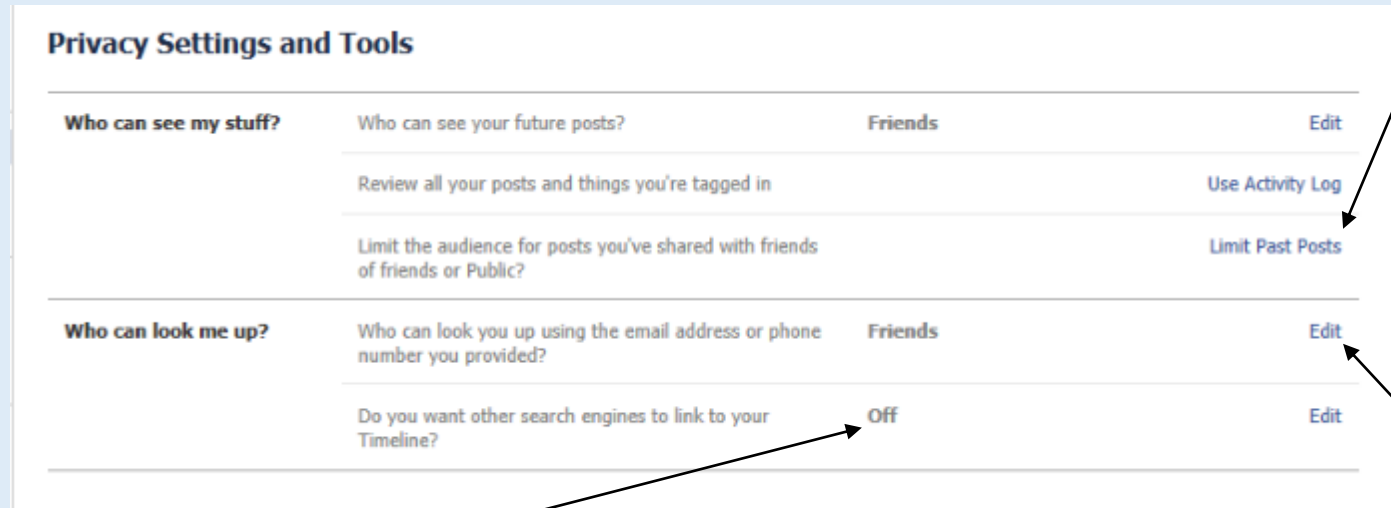

Hide your profile from search engines, if your name is typed into Google you and your posts will stay hidden

This is the safest of all the settings. It only applies to people who can't already see you email address and phone number

Restricting what appears on your timeline

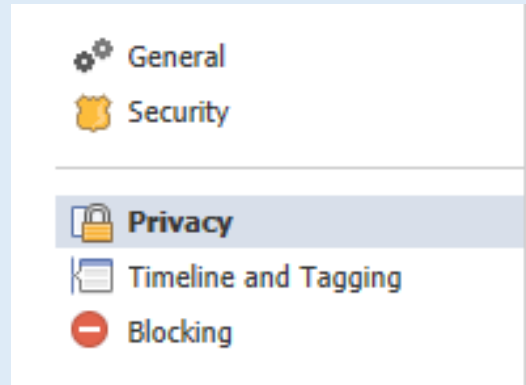

When in the privacy setting, this will appear on left hand side. **Click timeline and tagging**

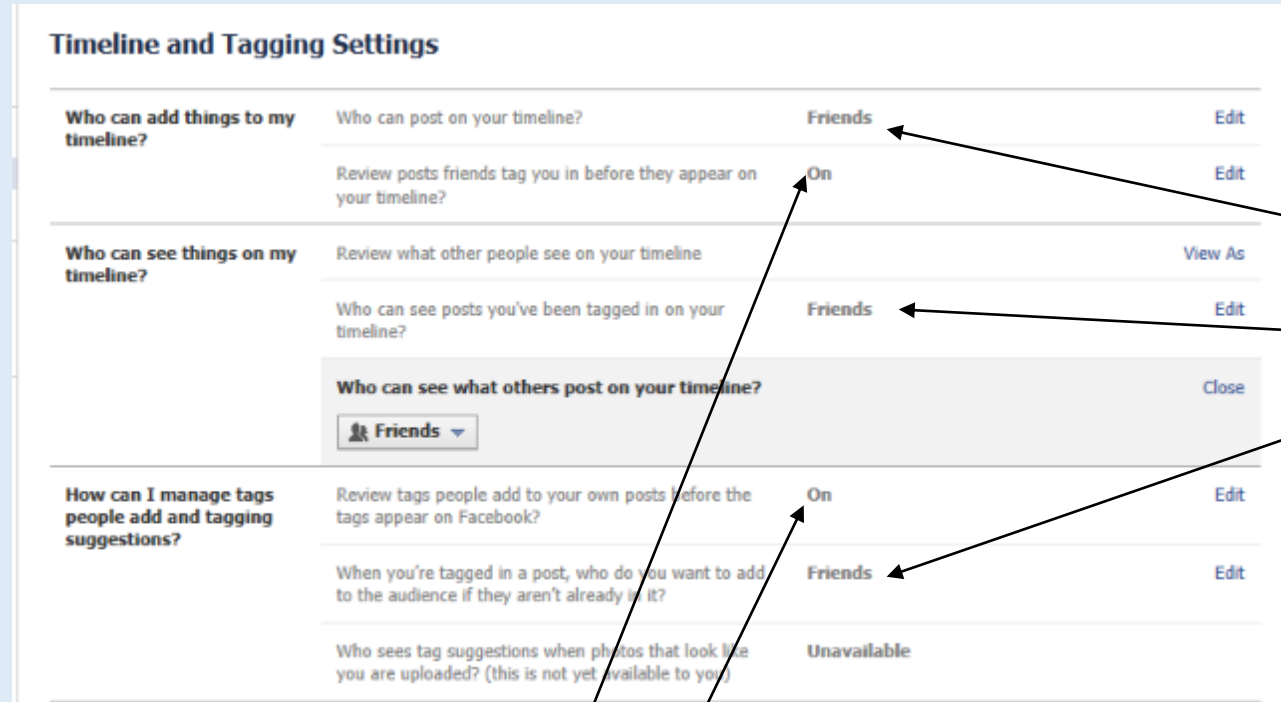

Check that only friends can see your posts

Set review tags to **On** to review tagged photos and before a post you are tagged in appears in your timeline

Top Facebook Tips

1. Don't set your profile picture or cover photo to a picture of you in your school uniform.
2. Don't accept friend requests from people you don't know.
3. Don't tell anyone your password and change it if you think someone knows it.
4. Use a strong password (like your school password – mix of capital letters, lower case letters and numbers)
5. If you are being bullied, keep all messages as proof.
6. Report any bullying to parents / carers / teachers / childline.

If you have any questions or concerns, speak to an ICT teacher.